

DRILL PRESS DIAGRAM - MODEL : DP750W16

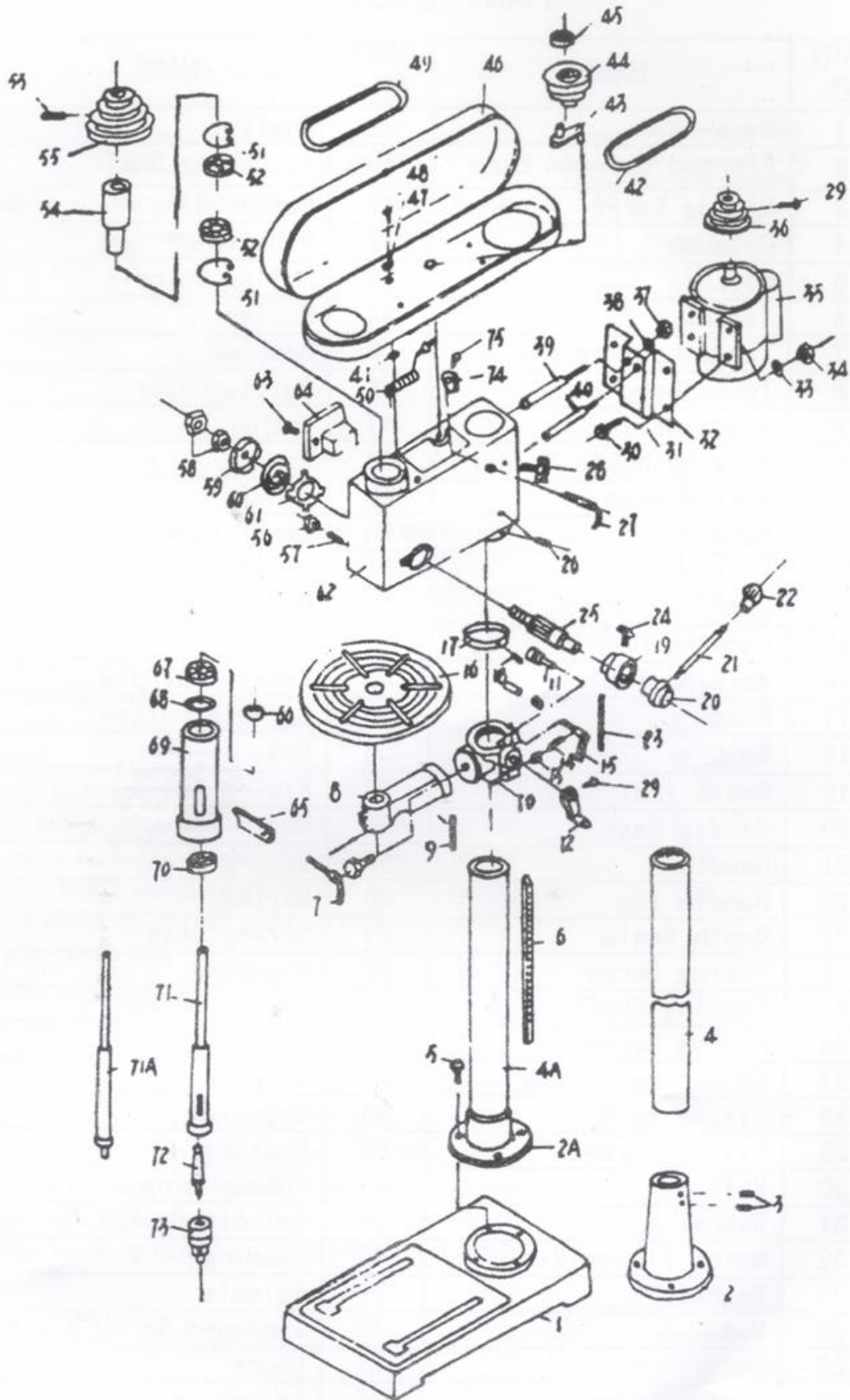



HEAVY DUTY DRILL PRESS

MODEL : DP750W16

SPARE PARTS LIST

No	Description	No	Description	No	Description
1	Base	28	Fixing Bolt	55	Spindle Pulley
2	Flanged Column Base	29	Fixing Screw	56	Nut
3	Fixing Screw	30	Bolt	57	Fixing Screw
4	Column	31	Washer	58	Nut
5	Bolt	32	Motor Fixing Plate	59	Spring Cover
6	Teeth	33	Washer		Spring With Spring Cover
7	Table Lock Handle (Bolt)	34	Nut	60	Spring
8	Table Bracket	35	Motor (Big)	61	Spring Seat
9	Angle Scale		Motor (Small)	62	Housing
10	Working Table Holder	36	Motor Pulley	63	Firing Screw
11	Worn Pinion	37	Nut	64	Switch
12	Handle (Crank)	38	Washer	65	Wedge
13	Gear	39	Shaft	66	C-Spring
14	In	40	Adjusting Shaft	67	Bearing
15	Locking Handle	41	Rubber Ring	68	Rubber Ring
16	Working Table	42	V-Belt (A-530)	69	Spindle Socket
17	Snap Ring	43	Pulley Spindle	70	Bearing
18	Bolt	44	Pulley	71	Spindle
19	Depth Indicator	45	Bearing	72	Tapped Spindle Tip
20	Handle Seat	46	Pulley Cover	73	Chuck
21	Handle	47	Washer		Chuck with key
22	Handle Tip	48	Bolt		Keyless Chuck
	Handle & Handle Tip	49	V-Belt (A565E)	74	Adjusting Block
23	Depth Scale	50	Electric	75	Bolt
24	Fixing Screw	51	C-Spring	76	Switch Seat
25	Feeding Shaft / Motor Fan	52	Bearing		18 & 20uf 450v Condenser
26	Fixing Screw	53	Nut		
27	Adjusting Handle	54	Keyway Spindle		