

# DRILL PRESS DIAGRAM - MODEL : DP375W13

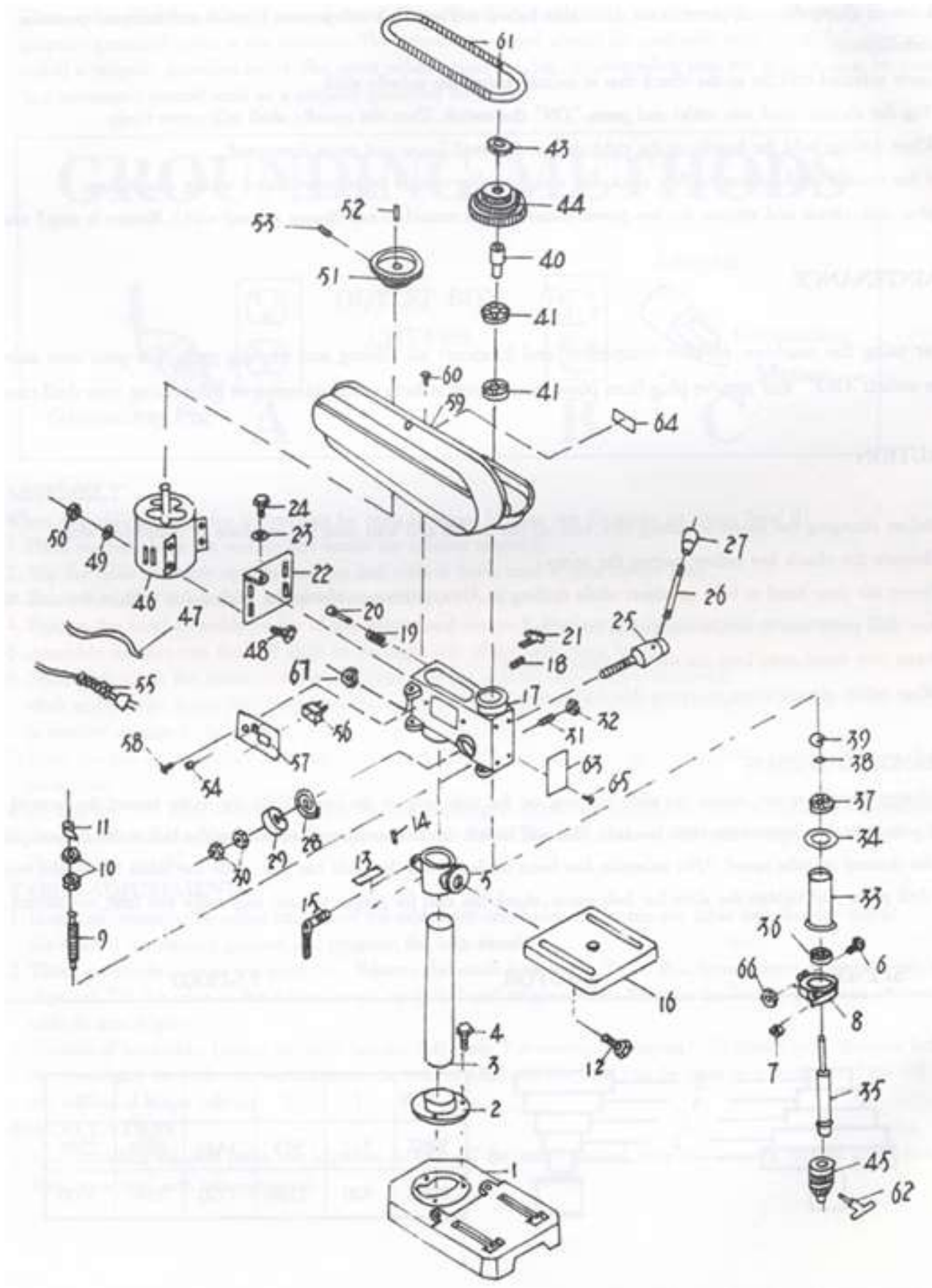



# HEAVY DUTY DRILL PRESS

## MODEL : DP375W13

### SPARE PARTS LIST

No	Description	No	Description	No	Description
1	Base	30	Nut	62	Chuck Key
2	Column Holder	31	Quill Set Screw	63	Label
3	Column		Nut	64	Speed Label
4	Bolt		Quill	65	Drive Screw
5	Working Table Holder		Rubber Washer	66	Nut
6	Headless Set Screw	35	Shaft	67	Nut
7	Nut	36	Ball Bearing		Condenser 7uf/8uf/10uf 450V
8	Set Ring	37	Ball Bearing		
9	Bolt Set	38	Retaining Ring		
10	Nut	39	Retaining Ring		
11	Scale	40	Driving Sleeve		
12	Pivot Bolt	41	Keyway Spindle & Ball Bearing		
13	Angle Scale	43	Pulley Set Nut		
14	Set Screw	44	Spindle Pulley		
15	Table Lock Handle	45	Drill Chuck with Key		
16	Table	46	Motor		
17	Head	47	Motor Wire		
18	Headless Screw	48	Bolt		
19	Spring	49	Washer		
20	Slider Bar	50	Nut		
21	Slider Bar Bolt	51	Motor Pulley		
22	Motor Base	52	Key		
23	Washer	53	Headless Set Screw		
24	Bolt	54	Wire Insulator		
25	Feed Shaft	55	Wire		
26	Handle Bar	56	Switch		
27	Grip	57	Switch Cover		
	Handle Bar & 1 Grip	58	Cross Head Set Screw		
28	Coil Spring	59	Pulley Cover-2pcs		
29	Spring 1Cover	60	Flat Screw		
	Coil Spring with Spring Cover	61	V-belt Wle (K-660)(K- 630)(K-620)		